

Poles	DIM.A	DIM.B	DIM.C
2P	2.50	7.45	10.00
3P	5.00	9.95	12.50
4P	7.50	12.45	15.00
5P	10.00	14.95	17.50
6P	12.50	17.45	20.00
7P	15.00	19.95	22.50
8P	17.50	22.45	25.00
9P	20.00	24.95	27.50
10P	22.50	27.45	30.00
11P	25.00	29.95	32.50
12P	27.50	32.45	35.00
13P	30.00	34.95	37.50
14P	32.50	37.45	40.00
15P	35.00	39.95	42.50
16P	37.50	42.45	45.00

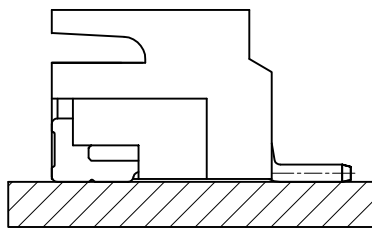

Assembly Layout

■ 技术参数 SPECIFICATIONS

- ◆ 适用线规: AWG#28~#22
Applicable Wire: AWG#28~#22
- ◆ 额定电压: 250V DC,AC(rms)
Rated voltage: 250V DC,AC(rms)
- ◆ 额定电流: 3A (AWG #22)
Rated Current: 3A (AWG #22)
- ◆ 耐压值: 1000V AC/minute
Withstand voltage: 1000V AC/min.
- ◆ 工作温度: -25°C ~ +85°C
Working Temp : -25°C ~ +85°C
- ◆ 绝缘电阻: ≥1000 MΩ
Insulation resistance: ≥1000 MΩ
- ◆ 接触电阻: ≤20 mΩ
Contact resistance: ≤20 mΩ

■ 材料 MATERIAL

- ◆ 绝缘体: 尼龙9T UL94-V0
Insulator: Nylon9T, UL94-V0
- ◆ 接触针: 黄铜
Contact PIN: Brass
- ◆ 焊片: 磷铜
Solder tab: Phosphor bronze

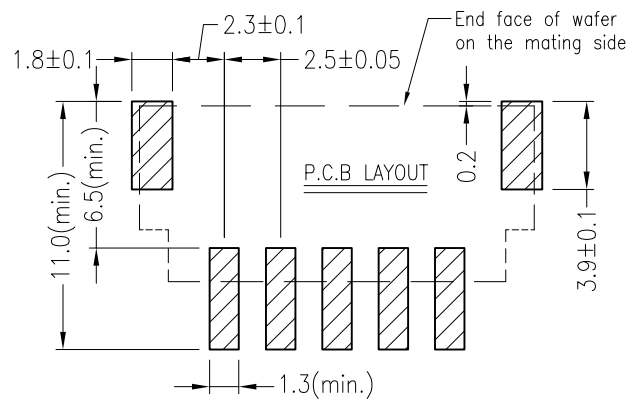

GENERAL TOLERANCE	
XX. ±0.40	
X. ±0.30	
.X ±0.25	X.* ± 2°
.XX ±0.15	.X.* ± 1°

SCALE:	4:1
UNIT:	mm
SIZE:	A4

DRAWN:	
CHECK:	
APPROVE:	

DATE:	
DATE:	
DATE:	

DOC. NO:	JD-Y-E69
PARTS NO:	XH-WT-NA

TITLE:	工程图
--------	-----

REV.	A
SHEET:	1/1