

For .110 (2.8) x .032 (.80) MINI BLADE FUSES

For Littelfuse Mini 297 or 997 series/Bussmann ATM series or equivalent

VERTICAL FUSE ENTRY

Thru Hole Mount



- Low Profile

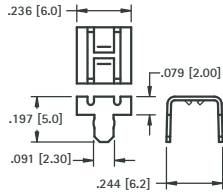

Mounting Detail For Two Clips

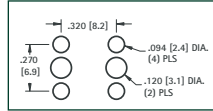

Pad Layout For Two Clips

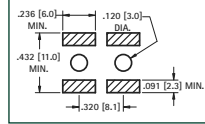

AVAILABLE ON TAPE AND REEL

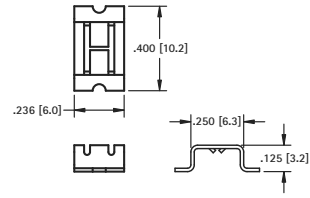

Surface Mount



- Low Profile

CAT. NO. 3583 (Bulk)

CAT. NO. 3583KTR (Tape & Reel)

Tape & Reel Spec's: 24mm wide; 12mm pitch; 13 inch reel (1500 pieces per reel)

CAT. NO. 3564

SPECIFICATIONS

Material: .012 (.30) Brass

Insulator: Glass filled Nylon, UL Rated 94V-0

UL Temperature Rating: -58°F to +292°F (-50°C to +145°C)

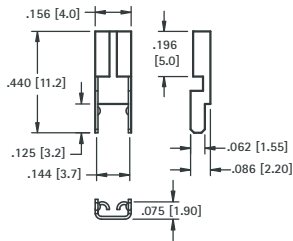

Mounting Detail For Two Clips

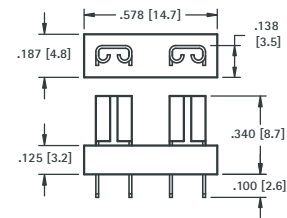
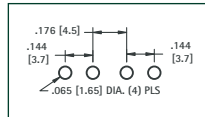

CAT. NO. 3544 Tin-Nickel Plate UL Current Rating: 30 Amps @ 500V AC

UL Current Rating: 20 Amps @ 500V AC CAT. NO. 3544-2 Tin Plate

LOW PROFILE MINI FUSE HOLDER

For Littelfuse Low Profile Mini (LP) series or equivalent

- Low insertion force
- Thru hole PC mountable, maintains position during wave soldering
- Fuse holder fully insulates clips to protect fuse from shorting
- Holder assures proper spacing and reduces assembly time

SPECIFICATIONS

Contacts: .016 (.41) Brass, Tin-Nickel Plate

Insulator: Nylon 4/6, UL Rated 94V-0

UL Current Rating: 30 Amps @ 500V AC

UL Temperature Rating: -58°F to +292°F (-50°C to +145°C)

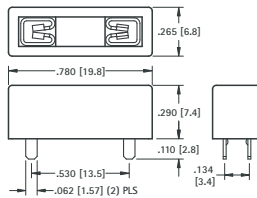
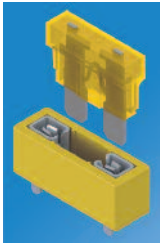

Mounting Detail

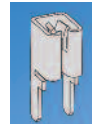
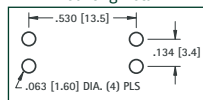

Refer to page 45 for Cat. No. 3557 Clip details

Mounting Detail

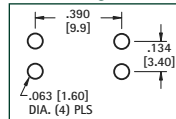

MINI FUSE HOLDER

For Littelfuse Mini 297 or 997 series/Bussmann ATM or equivalents

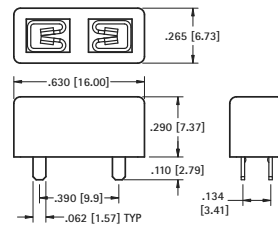

CAT. NO.	COLOR	FUSE REF.
3557-2	Black	-
3557-10	Red	10 Amp
3557-15	Blue	15 Amp
3557-20	Yellow	20 Amp

All colors UL rated for 30 Amp.

CAT. NO.	COLOR	FUSE REF.
3568	Black	-
3568-10	Red	10 Amp
3568-15	Blue	15 Amp
3568-20	Yellow	20 Amp

All colors UL rated for 30 Amp.

HORIZONTAL FUSE ENTRY

For Littelfuse Mini 297 or 997 series/Bussmann ATM series or equivalent

SPECIFICATIONS

Contacts: .012 (.30) Brass

Insulator: Nylon 6/6, UL Rated 94V-0

UL Temperature Rating: -58°F to +292°F (-50°C to +145°C)

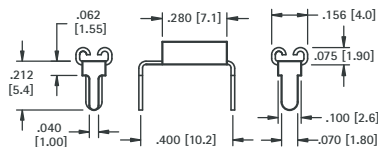

Mounting Detail For Two Clips

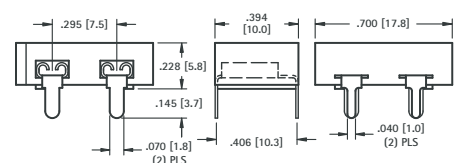
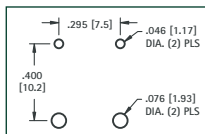

CAT. NO. 3549 Nickel Plate UL Current Rating: 30 Amps @ 500V AC

UL Current Rating: 20 Amps @ 500V AC CAT. NO. 3549-2 Tin Plate