

## Data Sheet

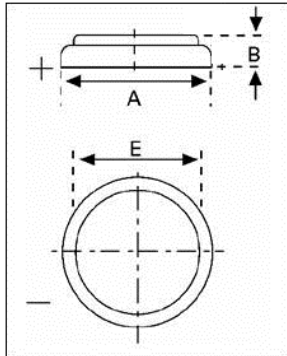

**Type Number** ..... 6032  
**Designation IEC** ..... CR 2032  
**System** ..... Li-Manganese dioxide / Organic Electrolyte  
**UL Recognition** ..... MH 13654  
**Nominal Voltage** ..... 3 V  
**Typical Capacity C** ..... 220 mAh  
 Load 5.6 kOhm, at 20°C down to 2 V  
**Weight (approx.)** ..... 3 g  
**Volume** ..... 0,95 ccm  
**Coding** ..... Date of Manufacturing DWWY

**Temperature Ranges**

	min.	max.
Storage .....	-55°C	70°C
Discharge .....	-20°C	70°C *)

**Dimensions**

	min.	max.
Diameter (A) .....	19,7	20,0
Height (B) .....	2,9	3,2
Shoulder Diameter (E) .....	16,0	

**Segment** ..... Electronic

**Main Applications** ..... Watch  
 Photo  
 Electronic

**Typical Capacities (at 20°C)**

Discharge Type	Load	End Voltage:	2.0 V
Continuous 24h/d,7d/w	5600 Ω	Time:	430 h
		Capacity [mAh]:	220
		Energy [mWh]:	610

\* Please note that extreme Temperatures can have an impact on Battery performance