

REVISIONS			
REV.	DCN No	DESCRIPTION	DATE
1	-	FIRST ISSUE	24/08/2012
1A	1398	LENGTH TABLE & LENGTH TOLS ADDED. P.SUTTON	18/03/2015
1B	1406	PARTS 12935 & 12936 ADDED TO TABLE. P.SUTTON	24/03/2015
2	1435	MANUFACTURER REQUEST. P.SUTTON	24/03/2016
2A	1543	TOLERANCE CLASS ADDED. M.WELLS	24/05/2017
2B	1567	TABLE UPDATED TO STANDARD LENGTHS ONLY. M.WELLS	11/04/2018

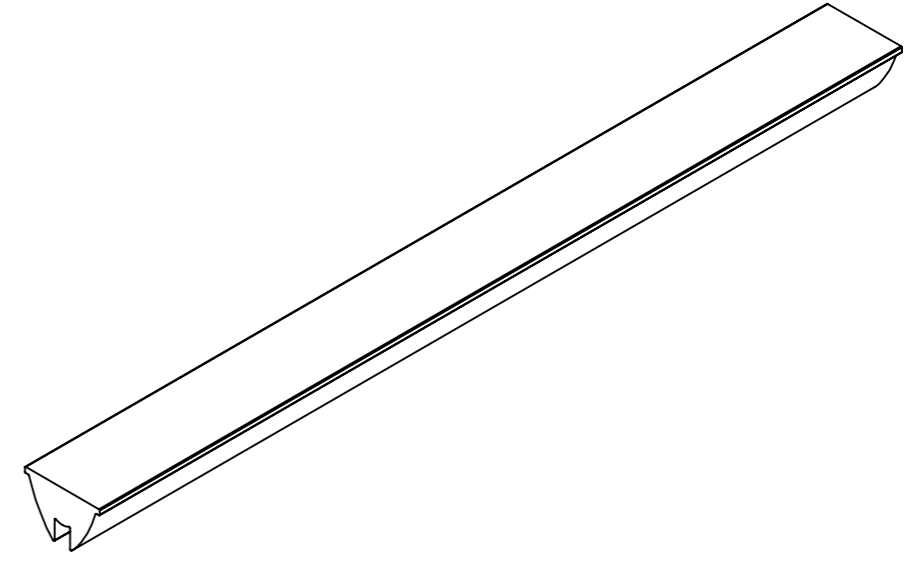
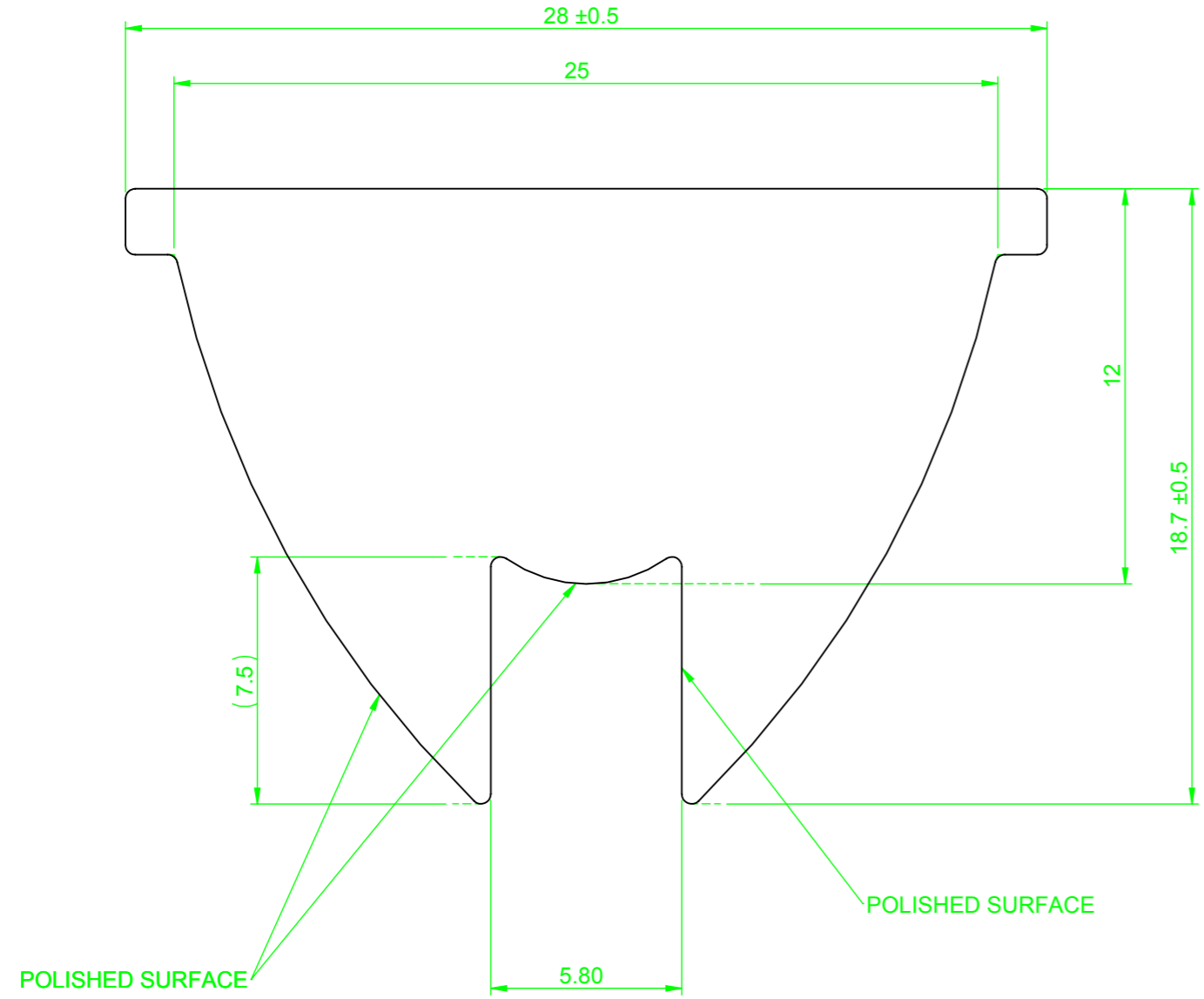

- NOTES:
- 1 - MATERIAL: PMMA
 - 2 - SURFACE FINISH:
POLISHED SURFACES SPI-A1
NOT SPECIFIED SURFACES SPI-A3
 - 4 - GENERAL DRAFT 2°
 - 5 - REFER TO 3D CAD FOR MISSING DIMENSIONS
 - 6 - ITEM () IS REFERENCE DIMENSION

PART No	LENGTH	TOLERANCE
12667	600 mm	$\pm 3,0$ mm
12750	300 mm	$\pm 3,0$ mm

CUSTOMER DRAWING

SHEET 2 OF 2

<p>Unit 6/7 Raban Lane, Aylesbury, HP19 8RY UK. Tel: +44(0) 01753 575 011 Fax: +44(0) 01753 811 359 sales@carclo-optics.com www.carclo-optics.com</p>	Title	EXTRUDED 28MM OPTIC - 10 DEGREE				
	Drawn by	ADC	Customer	CARCLO	Scale	5:1
THIRD ANGLE PROJECTION	GENERAL TOLERANCES UNLESS OTHERWISE STATED TO DIN16941 2A & 2B		DIMENSION IN mm		Format Size	A3
	CONFIDENTIAL: UNAUTHORISED COPYING, DISCUSSION & DISTRIBUTION PROHIBITED		CAD File	12667-70162_Rev2B		
	Part N°	12667	Drw N°	70162		