

D

15055-DA

150x172x55mm(5.9"x6.77"x2.17") **CE**



HOUSING	Aluminum Die Casting, Painted Blakk
IMPELLER	Thermoplastic PBT, UL94V-0
BEARING	Ball
OPERATING TEMPERATURE	-10°C to + 70°C
DIELECTRIC STRENGTH	5mA Max. at 500 VAC for 1 minute
INSULATION RESISTANCE	10M Ω min. @500 VDC
WEIGHT	1.03 kg
ROHS COMPLIANCE	Yes
IP LEVEL	IP54 (Special IP Rating On Request)

150

mm

SPECIFICATION

MODEL NO.	RATED VOLTAGE(V)	RATED CURRENT(A)	INPUT POWER(W)	SPEED (RPM)	MAX. AIR PRESSURE		MAX. AIR FLOW		NOISE dB(A) @1M
					inchH2O	mmH2O	CFM	m3/min	
D15055V12SLB-DA	12	3.73	44.76	4000	1.11	28.3	310	8.77	65
D15055V12HB-DA	12	2.75	33.00	3600	0.9	22.9	275	7.78	61
D15055V12MB-DA	12	1.88	22.56	3200	0.72	18.2	240	6.79	57
D15055V12LB-DA	12	1.31	15.72	2800	0.55	13.9	205	5.8	53
D15055V24SHB-DA	24	2.94	70.56	4800	1.56	39.7	375	10.61	73
D15055V24SMB-DA	24	2.41	51.36	4400	1.32	33.6	340	9.62	69
D15055V24SLB-DA	24	1.69	40.56	4000	1.11	28.3	310	8.77	65
D15055V24HB-DA	24	1.21	29.04	3600	0.9	22.9	275	7.78	61
D15055V24MB-DA	24	0.89	21.36	3200	0.72	18.2	240	6.79	57
D15055V24LB-DA	24	0.65	15.60	2800	0.55	13.9	205	5.8	53
D15055V48SHB-DA	48	1.48	71.04	4800	1.56	39.7	375	10.61	73
D15055V48SMB-DA	48	1.15	55.20	4400	1.32	33.6	340	9.62	69
D15055V48SLB-DA	48	0.79	37.92	4000	1.11	28.3	310	8.77	65
D15055V48HB-DA	48	0.60	28.80	3600	0.9	22.9	275	7.78	61
D15055V48MB-DA	48	0.45	21.60	3200	0.72	18.2	240	6.79	57
D15055V48LB-DA	48	0.33	15.84	2800	0.55	13.9	205	5.8	53

DIMENSION

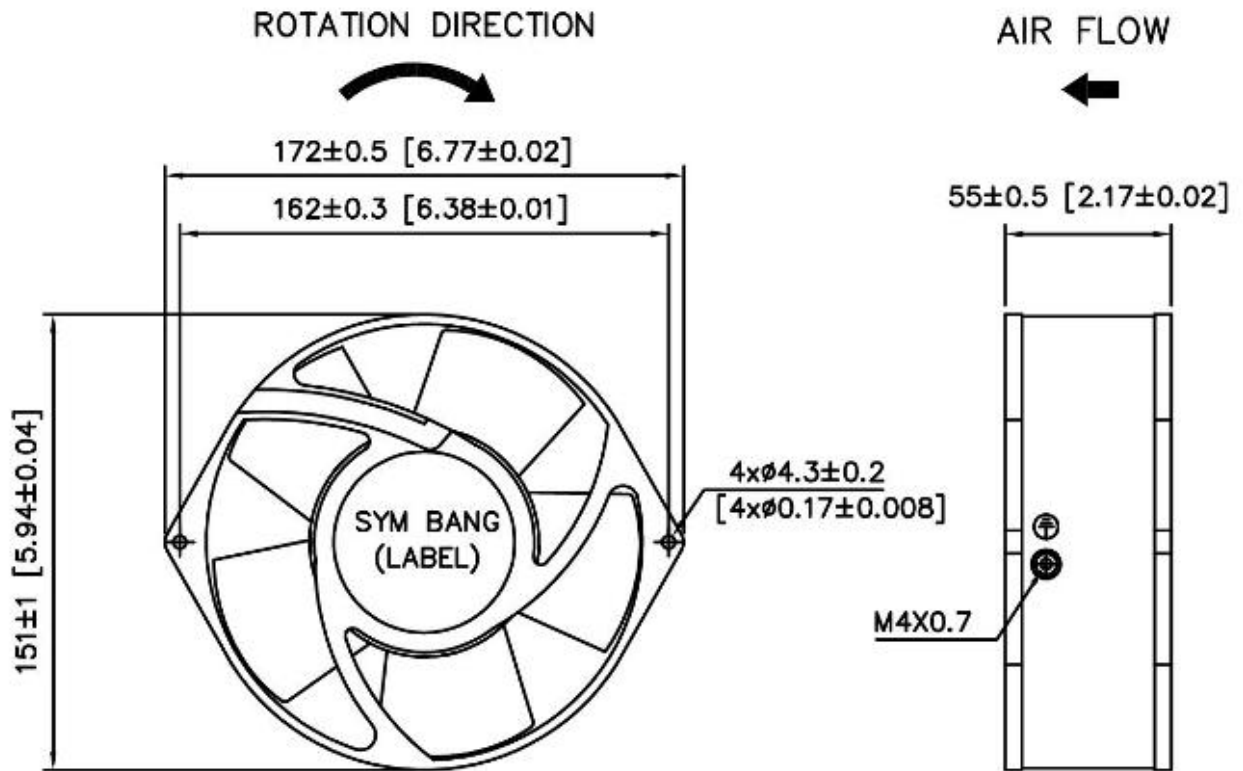

Mounting Panel Cutout
Outlet Side & Inlet Side

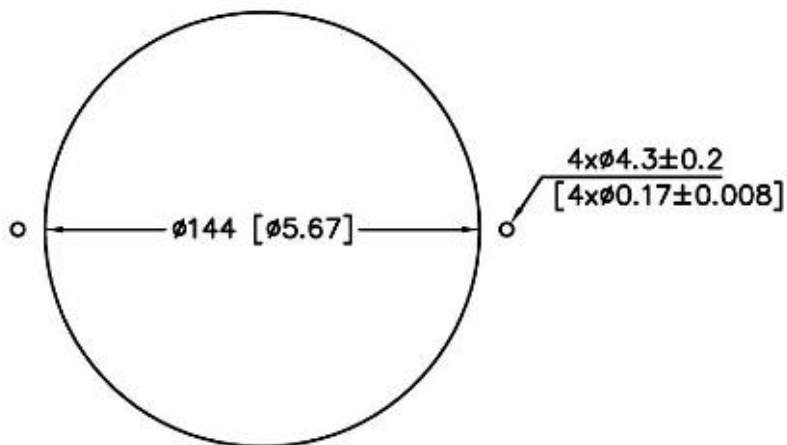

UNIT: mm[inch]

AIR PERFORMANCE

