

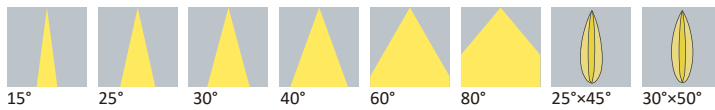

Datasheet
HQ Series

Available Distribution



Dimensions

Part Number	Diameter	Height
LL01CR-HQ×L06-M2	Ø16	10.3
LL01ZZ-HQ×L06-M×-T	Ø16.1	9.9
LL01CR-SN×L06-M×-T	Ø16.2	10.3
LL01CR-WJ×L06-M×	Ø16.1	10.3

*All dimensions are in millimeters.

LED



Packaging Details (SPQ)

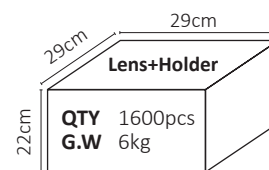

Recommad Applications



General Information

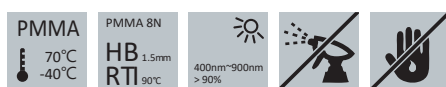

- Lens Material PMMA 8N
- Operating Temperature -40°C~+70°C
- UL Flammability HB @1.5mm
- UL RTI Elec 90°C @1.5mm
- Light Transmission Rate 400nm~900nm > 90%
- ☑ If necessary, Clean lenses with mild soap, water and soft cloth.
- ⚠ Never use any commercial cleaning solvents on lenses, like alcohol.
- 🧤 Please handle or install lenses with wearing gloves, skin oils may damage lens or its optical characteristic.

Accessories



- 4 Different Types of Holder
LL01CRCY30H×
LL01ZZZQ25H×
LL01CRSN30H×
LL01CRWJ30H×
- 2 Different Types of Tape
LL01A00ZBXX
LL01A40AXYXX

Mechanical Specification

*All dimensions are in millimeters.

Lens Dimension

LL01CR-HQxxL06

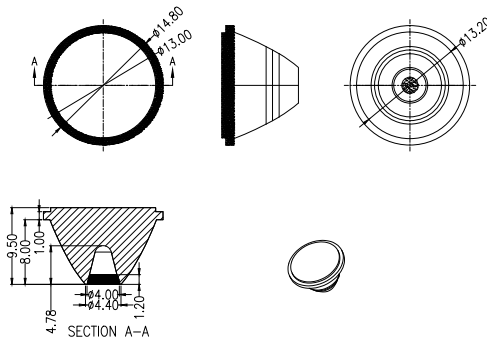

Holder Dimension

LL01CRCY30Hx

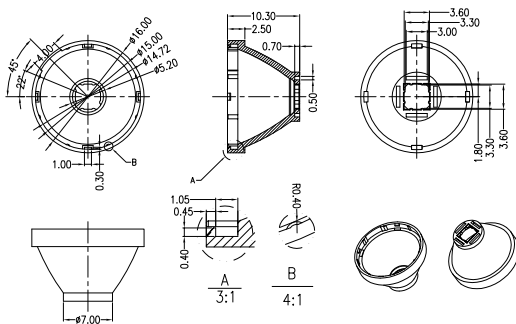

Assembly Instruction

Part No LL01CR-HQxxL06-M2
Holder LL01CRCY30Hx

Fixing Method



Luminarie
Accessories

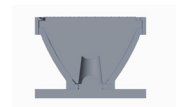
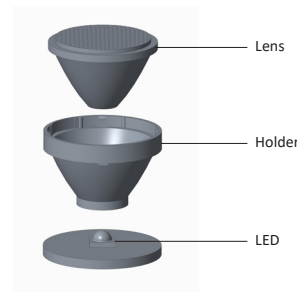

Holder Dimension

LL01ZZZQ25Hx

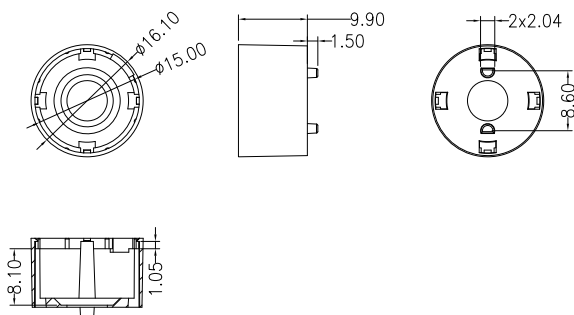

Assembly Instruction

Part No LL01ZZ-HQxxL06-Mx-T
Holder LL01ZZZQ25Hx
Tape LL01A00ZBXX

Fixing Method



Luminarie
Accessories



Holder Dimension



LL01CRSN30Hx

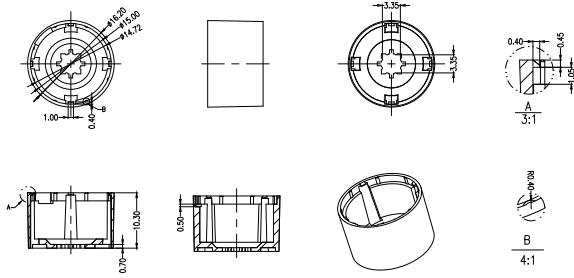

Assembly Instruction

Fixing Method

Part No LL01CR-SNxxL06-Mx-T
 Holder LL01CRSN30Hx
 Tape LL01A40AXYXX

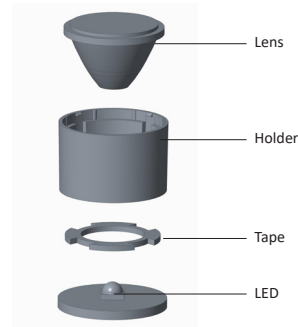

Holder Dimension



LL01CRWJ30Hx

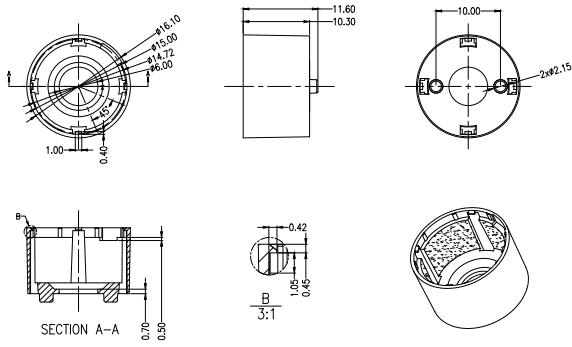

Assembly Instruction

Fixing Method

Part No LL01CR-WJxL06-Mx
Holder LL01CRWJ30Hx

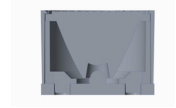
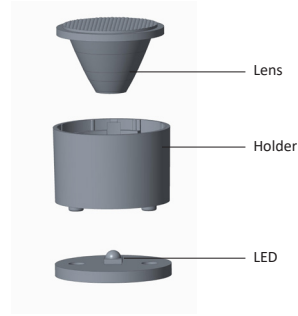

Assembly Instruction

Part No LL01CR-WJxL06-Mx
Holder LL01CRWJ30Hx

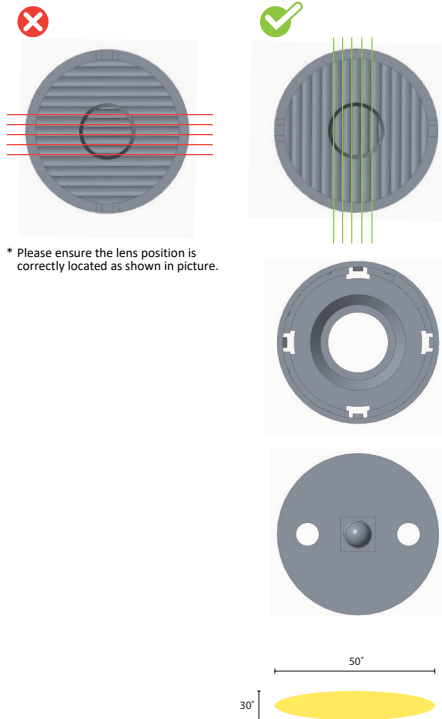

* Please ensure the lens position is correctly located as shown in picture.

Photometric Distribution

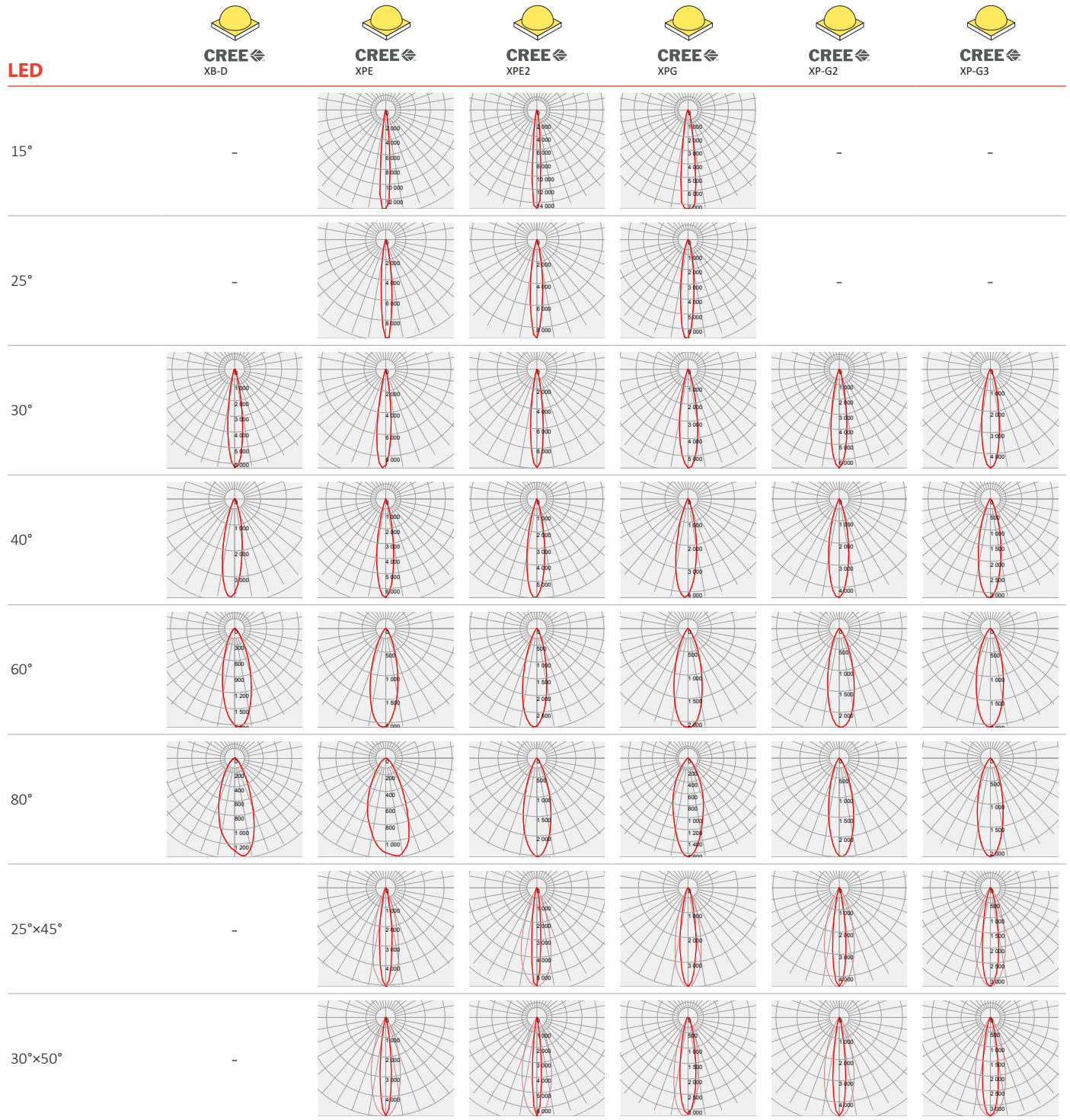

Photometric Distribution



NICHIA
NCS××19A

LED

15° -











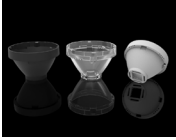

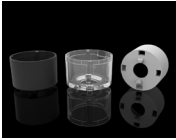
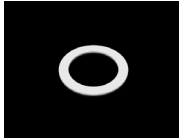

25° -



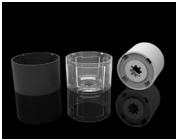



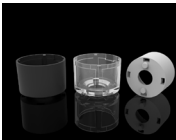



25°×45° -

30°×50° -

Details by LED

Part No	Holder	Tape	LED Package Size	LED
LL01CR-HQ××L06-M2	 LL01CRCY30H×	-	3535	 CREE XPE
LL01ZZ-HQ××L06-M×-T	 LL01ZZZQ25H×	 LL01A00ZBXX	3535	 CREE XPE  CREE XPE2  CREE XPG  CREE XP-G2  CREE XP-G3
LL01CR-SN××L06-M×-T	 LL01CRSN30H×	 LL01A40AXYXX	3535	 CREE XPE2  CREE XP-G3
LL01CR-WJ××L06-M×	 LL01CRWJ30H×	-	2525 / 3535	 CREE XB-D  NICHIA NCS××19A

LED	Part No	FWHM	cd / lm	IES	
 CREE XB-D	LL01CR-WJ15L06-M2	-	-	-	
	LL01CR-WJ25L06-M2	-	-	-	
	LL01CR-WJ30L06-M2	17°	6.2	↓	
	LL01CR-WJ40L06-M2	22°	3.7	↓	
	LL01CR-WJ60L06-M2	33°	1.8	↓	
	LL01CR-WJ80L06-M2	39°	1.3	↓	
	LL01CR-WJ2545L06-M2	-	-	-	
	LL01CR-WJ3050L06-M2	-	-	-	
 CREE XPE	LL01CR-HQ15L06-M2	10°	13.2	↓	
	LL01CR-HQ25L06-M2	12°	9.7	↓	
	LL01CR-HQ30L06-M2	15°	9.0	↓	
	LL01CR-HQ40L06-M2	19°	6.5	↓	
	LL01CR-HQ60L06-M2	31°	2.0	↓	
	LL01CR-HQ80L06-M2	45°	1.1	↓	
	LL01CR-HQ2545L06-M2	14°x28°	5.0	↓	
	LL01ZZ-HQ15L06-Mx-T	10°	13.2	↓	
	LL01ZZ-HQ25L06-Mx-T	12°	9.7	↓	
	LL01ZZ-HQ30L06-Mx-T	15°	9.0	↓	
	LL01ZZ-HQ40L06-Mx-T	19°	6.5	↓	
	LL01ZZ-HQ60L06-Mx-T	31°	2.0	↓	
	LL01ZZ-HQ80L06-Mx-T	45°	1.1	↓	
	LL01ZZ-HQ2545L06-Mx-T	14°x28°	5.0	↓	
	LL01ZZ-HQ3050L06-Mx-T	13°x33°	4.9	↓	
	 CREE XPE2	LL01ZZ-HQ15L06-Mx-T	9°	14.9	↓
		LL01ZZ-HQ25L06-Mx-T	14°	8.9	↓
		LL01ZZ-HQ30L06-Mx-T	14°	9.9	↓
LL01ZZ-HQ40L06-Mx-T		20°	5.9	↓	
LL01ZZ-HQ60L06-Mx-T		27°	2.9	↓	
LL01ZZ-HQ80L06-Mx-T		31°	2.5	↓	
LL01ZZ-HQ2545L06-Mx-T		10°x32°	5.6	↓	
LL01ZZ-HQ3050L06-Mx-T		10°x33°	6.5	↓	
LL01CR-SN15L06-Mx-T		9°	14.3	↓	
LL01CR-SN25L06-Mx-T		14°	8.6	↓	
LL01CR-SN30L06-Mx-T		14°	9.5	↓	
LL01CR-SN40L06-Mx-T		20°	5.7	↓	
LL01CR-SN60L06-Mx-T		27°	2.8	↓	
LL01CR-SN80L06-Mx-T		31°	2.4	↓	
LL01CR-SN2545L06-Mx-T		10°x32	5.4	↓	
LL01CR-SN3050L06-Mx-T		10°x34	6.4	↓	
 CREE XPG		LL01ZZ-HQ15L06-Mx-T	15°	7.3	↓
		LL01ZZ-HQ25L06-Mx-T	15°	6.6	↓
	LL01ZZ-HQ30L06-Mx-T	20°	5.6	↓	
	LL01ZZ-HQ40L06-Mx-T	23°	4.2	↓	
	LL01ZZ-HQ60L06-Mx-T	35°	1.8	↓	
	LL01ZZ-HQ80L06-Mx-T	53°	0.9	↓	
	LL01ZZ-HQ2545L06-Mx-T	18°x29°	3.9	↓	
	LL01ZZ-HQ3050L06-Mx-T	18°x28°	3.2	↓	

LED	Part No	FWHM	cd / lm	IES	
 CREE XP-G2	LL01ZZ-HQ15L06-Mx-T	-	-	-	
	LL01ZZ-HQ25L06-Mx-T	-	-	-	
	LL01ZZ-HQ30L06-Mx-T	18°	6.5	↓	
	LL01ZZ-HQ40L06-Mx-T	23°	4.4	↓	
	LL01ZZ-HQ60L06-Mx-T	30°	2.3	↓	
	LL01ZZ-HQ80L06-Mx-T	29°	2.5	↓	
	LL01ZZ-HQ2545L06-Mx-T	15°x34°	4.4	↓	
	LL01ZZ-HQ3050L06-Mx-T	14°x33°	4.6	↓	
	 CREE XP-G3	LL01ZZ-HQ15L06-Mx-T	-	-	-
		LL01ZZ-HQ25L06-Mx-T	-	-	-
LL01ZZ-HQ30L06-Mx-T		20°	4.6	↓	
LL01ZZ-HQ40L06-Mx-T		26°	3.1	↓	
LL01ZZ-HQ60L06-Mx-T		31°	2.0	↓	
LL01ZZ-HQ80L06-Mx-T		30°	2.1	↓	
LL01ZZ-HQ2545L06-Mx-T		18°x34°	3.2	↓	
LL01ZZ-HQ3050L06-Mx-T		18°x34°	3.3	↓	
 NICHIA NCSxx19A		LL01CR-SN15L06-Mx-T	-	-	-
		LL01CR-SN25L06-Mx-T	-	-	-
	LL01CR-SN30L06-Mx-T	20°	4.5	↓	
	LL01CR-SN40L06-Mx-T	26°	3.1	↓	
	LL01CR-SN60L06-Mx-T	31°	2.0	↓	
	LL01CR-SN80L06-Mx-T	30°	2.1	↓	
	LL01CR-SN2545L06-Mx-T	18°x34°	3.2	↓	
	LL01CR-SN3050L06-Mx-T	18°x34°	3.3	↓	
	 NICHIA NCSxx19A	LL01CR-WJ15L06-M2	-	-	-
		LL01CR-WJ25L06-M2	-	-	-
LL01CR-WJ30L06-M2		16°	7.6	↓	
LL01CR-WJ40L06-M2		21°	4.7	↓	
LL01CR-WJ60L06-M2		31°	1.9	↓	
LL01CR-WJ80L06-M2		37°	1.5	↓	
LL01CR-WJ2545L06-M2		-	-	-	
LL01CR-WJ3050L06-M2	-	-	-		

Product Nomenclature

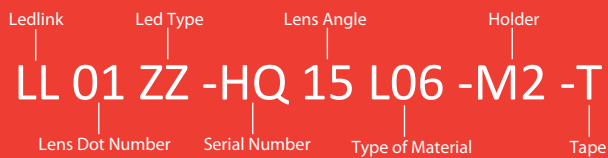

Ledlink Optics, Inc

Taiwan HQ

15F, No.655, Bannan Rd., Chung-Ho Dist.,
New Taipei City, Taiwan 235

Ledlink Optics (Dongguan) Co., Ltd

Dongguan Factory

No.5, TianKeng Industrial Dist., HengLiTown, DongGuan City,
GuangDong Province, China 523478

Ledlink Optics (Yangzhou) Co., Ltd

Yangzhou Factory

No.180, LinJiang Rd., YangZhou City, Jiangsu Province, China 225009

www.ledlink-optics.com

service@ledlink-optics.com

