

**Underwriters Laboratories, Inc.**  
**Recognized Component Program —**  
**UL File Number E201546**



UL file number E201546 has been assigned to Keystone Electronics' "Quick-Fit" terminals (Refer to pages 64-68) indicating recognition by Underwriters Laboratories Inc. that they are in compliance with their component program.

Underwriters Laboratories Inc. component program assures that "Quick-Fit" terminals meet the dimensional and performance requirements of the National Electrical Manufacturers Association specification number NEMA2-1982-(1988) and UL310.



**.110 (2.8) TAB**

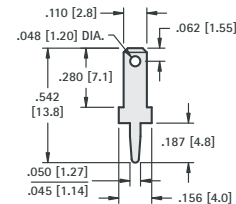

CAT. NO.	MATERIAL	MTG. HOLE
<b>1267</b>	.020 (.50) Brass, Tin Plate	.046 (1.2) Dia.
<b>1211</b>	.032 (.81) Brass, Tin Plate	.052 (1.3) Dia.

**.110 (2.8) TAB**

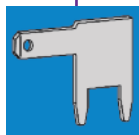
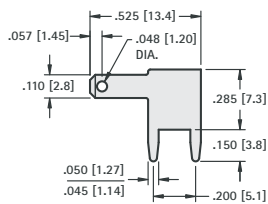

**.110 (2.8) & .187 (4.8) TAB**

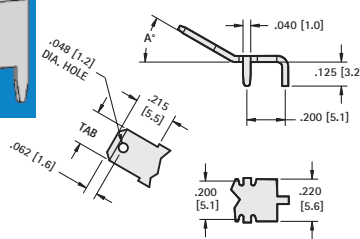

**Material:** .020 (.50) Brass, Tin Plate  
**Mtg Holes:** .046 (1.2) Dia.

.110 (2.8) TAB CAT. NO.	A ANGLE	.187(4.8) TAB CAT. NO.
<b>4915*</b>	0°	<b>4918*</b>
<b>4916*</b>	30°	<b>4919*</b>
<b>4917*</b>	60°	<b>4920*</b>

CAT. NO.	MATERIAL	MTG. HOLES
<b>4903</b>	.020 (.50) Brass, Tin Plate	.046 (1.2) Dia.
<b>4906</b>	.032 (.81) Brass, Tin Plate	.052 (1.3) Dia.

**.187 (4.8) TAB**

**STURDI-MOUNT**

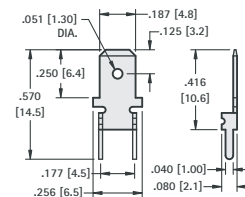

CAT. NO.	MATERIAL	MTG. HOLES
<b>4900</b>	.020 (.50) Brass, Tin Plate	.043 (1.1) Dia.

**.187 (4.8) TAB**

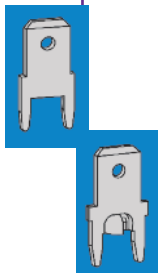
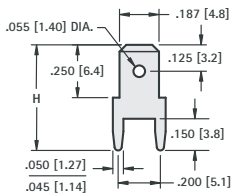

**.187 (4.8) TAB**

**STURDI-MOUNT**

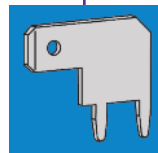
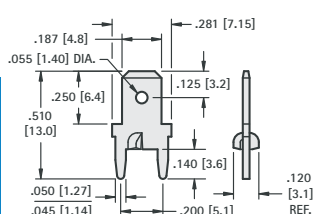

**Material:** Brass, Tin Plate

CAT. NO.	H	MATL THICK	MTG. HOLES
<b>1285</b>	.500 (12.7)	.020 (.50)	.046 (1.2) Dia.
<b>1212</b>	.500 (12.7)	.032 (.81)	.052 (1.3) Dia.
<b>1216</b>	.860 (21.8)	.032 (.81)	.052 (1.3) Dia.

CAT. NO.	MATERIAL	MTG. HOLES
<b>1285-ST</b>	.020 (.50) Brass, Tin Plate	.046 (1.2) Dia.
<b>1212-ST</b>	.032 (.81) Brass, Tin Plate	.052 (1.3) Dia.

**.187 (4.8) TAB**

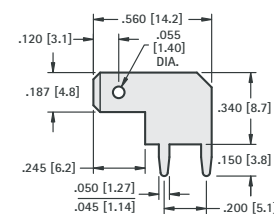

CAT. NO.	MATERIAL	MTG. HOLES
<b>4904</b>	.020 (.50) Brass, Tin Plate	.046 (1.2) Dia.
<b>4907</b>	.032 (.81) Brass, Tin Plate	.052 (1.3) Dia.

**.205 (5.2) TAB**

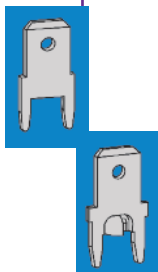
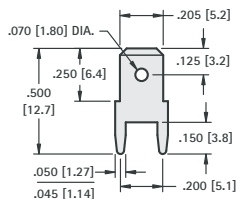

**.205 (5.2) TAB**

**STURDI-MOUNT**

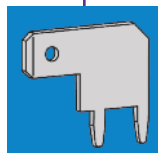
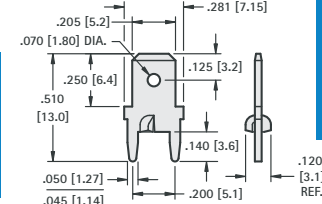

CAT. NO.	MATERIAL	MTG. HOLES
<b>1286</b>	.020 (.50) Brass, Tin Plate	.046 (1.2) Dia.
<b>1213</b>	.032 (.81) Brass, Tin Plate	.052 (1.3) Dia.

CAT. NO.	MATERIAL	MTG. HOLES
<b>1286-ST</b>	.020 (.50) Brass, Tin Plate	.046 (1.2) Dia.
<b>1213-ST</b>	.032 (.81) Brass, Tin Plate	.052 (1.3) Dia.

**.205 (5.2) TAB**

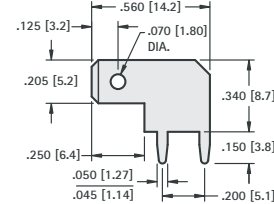

CAT. NO.	MATERIAL	MTG. HOLES
<b>4905*</b>	.020 (.50) Brass, Tin Plate	.046 (1.2) Dia.
<b>4909*</b>	.032 (.81) Brass, Tin Plate	.052 (1.3) Dia.

\* Not UL Recognized