

RUGGED STEEL BATTERY CLIPS

"AA" - "C" - "D"

Refer to page 41 for Battery Contact Layout & Mounting Details

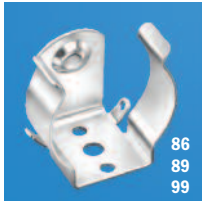

Non-Insulated

Base: Steel, Nickel Plate
Contacts: Brass, Nickel Plate

- Available with and without insulated contact
- Non-Insulated contact will ground battery connection
- Insulated Contacts supplied with brass solder lug
- Ideal for creating custom battery holders



Insulated

CAT. NO.	FIGURE	L	W	H	CELL SIZE
99	Non-Insulated	.703 (17.9)	.359 (9.1)	.609 (15.5)	"AA"
100	Insulated				
86	Non-Insulated	.703 (17.9)	.606 (15.4)	.953 (24.2)	"C"
87	Insulated				
89	Non-Insulated	.780 (19.8)	.606 (15.4)	1.160 (29.5)	"D"
88	Insulated				

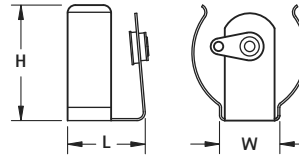

ECONOMY CONTACTS

"AA" - "C" - "D"

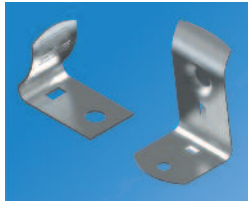

Refer to page 41 for Battery Contact Layout & Mounting Details

- Designed for mounting in self-contained, non-metallic battery compartments
- Reliable spring tension assures low contact resistance
- Recessed contact holds battery in place
- All clips have anti-rotation tab

CAT. NO.	L	W	H	CELL SIZE
206	.625 (15.9)	.375 (9.5)	.500 (12.7)	"AA"
207	.687 (17.4)	.375 (9.5)	.875 (22.2)	"C"
208	.750 (18.1)	.687 (17.5)	1.260 (32.0)	"D"

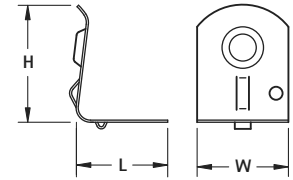

MATERIAL: .016 (.41) Spring Steel, Nickel Plate

ALUMINUM & STEEL CLIPS

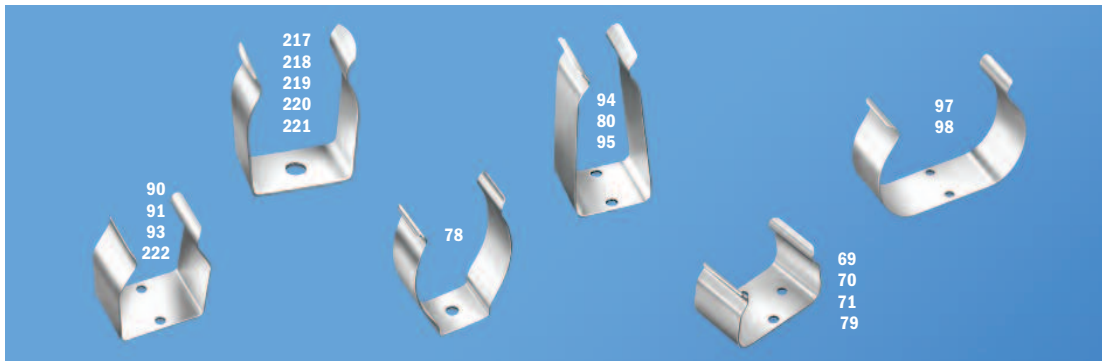

MATERIAL: Steel Clips: Spring Steel, Nickel Plate Aluminum Clips: 2024-T3

CAT. NO.	DESCRIPTION	MATERIAL
"AAAA" Cell (7.5 - 8.5mm Dia)		
251	One cell	Steel
"AAA" Cell (9.5 - 12mm Dia)		
90	One cell	Aluminum
"AA", "CR2" Cell (13.5 - 17.0mm Dia)		
91	One cell	Aluminum
69	Two Cell	Steel
"A" Cell (16.0 - 18.0mm Dia)		
70	Two Cell	Aluminum

CAT. NO.	DESCRIPTION	MATERIAL
Sub C Cell (22.0 - 23.0mm Dia)		
221	One cell	Steel
C Cell (22.0 - 29.0mm Dia)		
222	One cell	Steel
93	One cell	Aluminum
97	Two Cell	Aluminum
D Cell (30.0 - 35.0mm Dia)		
94	One cell	Aluminum
78	One cell	Steel
98	Two Cell	Aluminum

CAT. NO.	DESCRIPTION	MATERIAL
NiCd Cell		
217	One cell, 35-38mm Dia.	Steel
218	One cell, 36-43mm Dia.	Steel
219	One cell, 51-64mm Dia.	Steel
9V Cell		
71	Horizontal, Low Profile	Steel
79	Horizontal	Steel
80	Vertical	Steel
95	Vertical	Aluminum
66	Horizontal, Lithium-Ion	Steel

BATTERY RETAINER CLIPS



- Prevents battery from loosening in battery holder
- Retainer clip slips on the ears of the battery holder clip

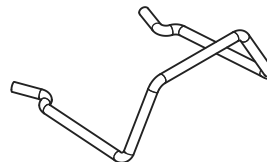

CAT. NO.	CELL	CAN BE USED WITH CAT. NO.s
61	"AA", "CR2"	91, 92, 95, 99, 100, 2915
62	"C"	86, 87, 93, 222
63	"D"	78, 88, 89, 94