

ORION AC Cooling Fans



92 X 92 X 25mm (3.62" X 3.62" X 1.0")



- Motor** Shaded pole, impedance protected
- Frame/Housing** Aluminum die-cast
Painted black (AP)
- Impeller** Glass reinforced thermoplastic, (UL94V-0)
- Bearing System** Dual Ball Bearing or Sleeve
- Dielectric Strength** 1 min. at 1,500VAC, 50/60Hz.
- Operating Temperature** Ball bearing -20°C~+75°C
Sleeve Bearing -10°C~+60°C
- Life Expectancy at 40°C** Ball bearing 60,000 hours (L10)
Sleeve bearing 30,000 hours (L10)
- Safety Approvals** UL, CUL, TÜV

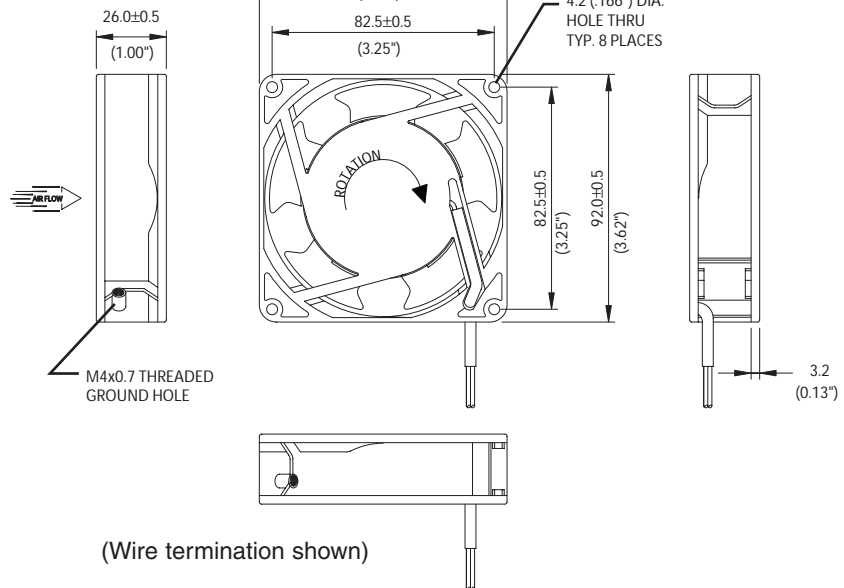
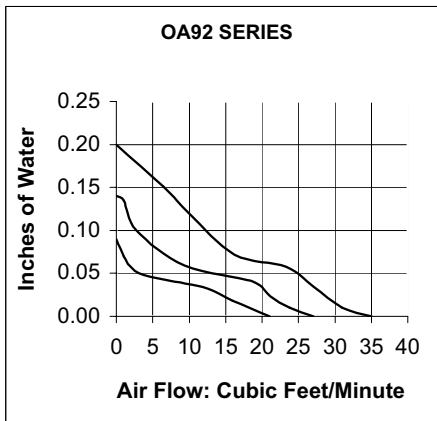
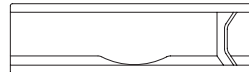

Model Number	Speed (RPM)	Max CFM	Noise (dB)	Volts	Voltage Range	Watts	Max. Static Pressure Inches
OA92AP-11-1 [] ()	3000	35	30	115	80 ~ 130	13	.20
OA92AP-11-2 [] ()	2300	27	22	115	80 ~ 130	10	.14
OA92AP-11-3 [] ()	1600	21	19	115	80 ~ 130	6	.09
OA92AP-22-1 [] ()	3000	35	30	230	160~260	13	.20
OA92AP-22-2 [] ()	2300	27	22	230	160~260	10	.14
OA92AP-22-3 [] ()	1600	21	19	230	160~260	6	.09
OA92AP-11/22-1WB (Dual Voltage) *	3000	35	30	115/230	80 ~ 260	13	.20
OA92AP-11/22-2WB (Dual Voltage) *	2300	27	22	115/230	80 ~ 260	10	.14
OA92AP-11/22-3WB (Dual Voltage) *	1600	21	19	115/230	80 ~ 260	6	.09

* Dual voltage AC fans are equipped with 4 lead wires. Please see wiring diagram on fan label,

[] Indicate [T] Terminal or [W] Wire () Indicate [B] Ball or [S] Sleeve

OTHER available dual voltages:

- 120/240 Dual VAC, 50/60 Hz
- 240/480 Dual VAC, 50/60 Hz
- 12/24 Dual VAC, 50/60 Hz
- 24/48 Dual VAC, 50/60 Hz

Accessory Information:

- Finger Guard: G92-16
- Plastic Guard: G92P
- Aluminum Filter: WMG 92M
- Filter Kit: GRM92-30
- Power Cord: (Any configuration)