

B-120/C

BNC MALE TERMINATORS METAL CAP

(A) FOR 50 Ω 1/2W \pm 5%

(B) FOR 75 Ω 1/2W \pm 5%

(C) FOR 93 Ω 1/2W \pm 5%

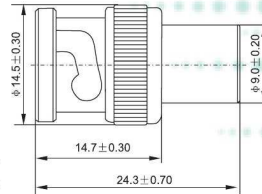
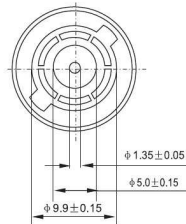

A	RENINTOR
A-50 Ω	A/2WX50 Ω 1%
B-75 Ω	1/2WX75 Ω 1%
C-93 Ω	1/2WX98 Ω 1%

