

*Change new drawing frame in Blue Color since 2009/07/01, to comply with Company CIS Policy.

Revisions

ISS	Symbol	Explanation	Date
B		CHE to New Drawings Frame & PN System.	2006/07/10
B-1		CHE the DIM fm $\phi 2.3$ & 16.5 to $\phi 2.1$ & 15.5 .	2009/08/13
B-2		CHE the DIM fm $\phi 3.1$, $\phi 2.9$ & 14.1 to $\phi 3.2$, $\phi 3$ & 14 .	2017/07/05

Notes :

- Any Electrical, Mechanical or Environmental Test Per MIL-PRF-39012F Should be Spotlighted, As We May Not Have All Testing Equipment to Cover All of It.
- Single Crimp: Recommended Dimensions Provided for Ferrule.
Dual Crimp: Recommended Dimensions Provided for Ferrule And Inner Contact.
Please Advise Single/Dual in Advance to Avoid Any Inconvenience.
- All Metal Materials Are in Compliance with RoHS 2 Directive 2011/65/EU Annex III Section 6 Paragraph.
- Recommended Crimped Hand Tool : for P/N - **HT-801G**

Outline Drawing

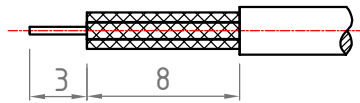
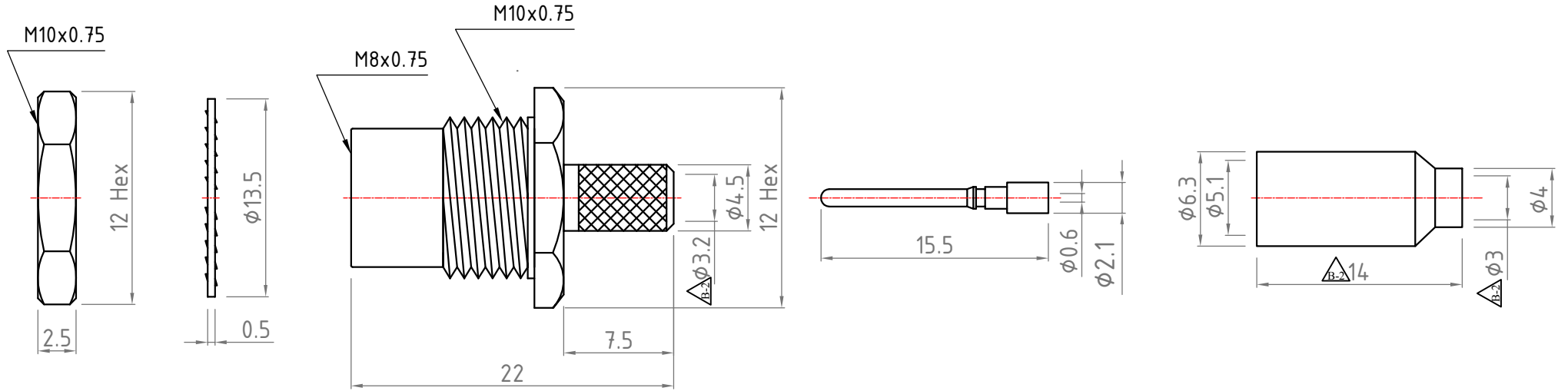

Recommended Cable Stripping Dimensions

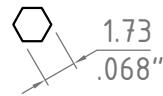

Recommended Crimping Dimensions for Inner Contact

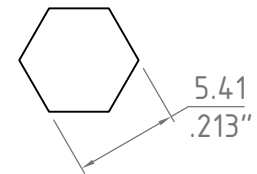

Recommended Crimping Dimensions for Ferrule

Finish [Unit of Plating Thickness Is in Micro Inch(μ)]

- Nickel Plating Thk. : 70 μ " min. (Under Plating)
- Gold Plating Thk. : 2 μ " max. (Over Finish 1)

Electrical :

Impedance : 50 Ω
 Frequency Range : 0~12.4 GHz.
 Voltage Rating : 500 V rms (depending on cable)
 Insulator Resistance : ≥ 5 G Ω
 Dielectric Withstanding Voltage : 1000 V rms.
 Contact Resistance : Center Contact ≤ 10.0 m Ω .
 Outer Contact ≤ 5.0 m Ω .
 Insertion loss : ≤ 0.1 dB max/1GHz typ
 VSWR : ≤ 1.22 typ

ITEM	Description	Material	Finish	Part Number	QTY
5	Nut	Brass	Finish 1		
5	Lock Washer	Brass	Finish 1		
4	Ferrule	Brass	Finish 1		
3	Inner Contact	Brass	Finish 1/2		
2	Insulator	Delrin	None		
1	Body	Brass	Finish 1		

*RoHS and REACH are fully complied to create a greener planet for future generations.

Scale	Abbr.	Date	Rev.
NTS	ST	2017/07/06	B-2
Tolerances :		Proprietary Note	
.X ± 0.2		This document contains information proprietary to S-Conn, which is either copyrighted, or patent applied for, and / or protected by trade secret laws.	
.XX ± 0.1		This document or parts thereof, may not be used, disclosed or reproduced in any form by any method, or for any purpose, without the written permission of S-Conn, Taiwan	
.XXX ± 0.05			
Angular :			
.X $\pm 1^\circ$			
Drawn	Checked	Approved	
Louis	Mark	H. Sun	
2017/07/06	2017/07/06	2017/07/06	



DWG. NO.	CUSTOMER P/N:	TITLE
A108D0N02-M-1		FME S/T Plug, Dual Crimp Type for RG174, 188, 316, B7805A, URM95, LMR100 Cable
S-Conn Enterprise Co., Ltd.		

Outline verified
 DIM verified
 TXT verified

