

REV.	DESCRIPTION	DRAWN	CHECKED	APPROVED

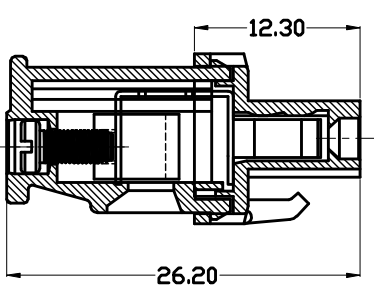
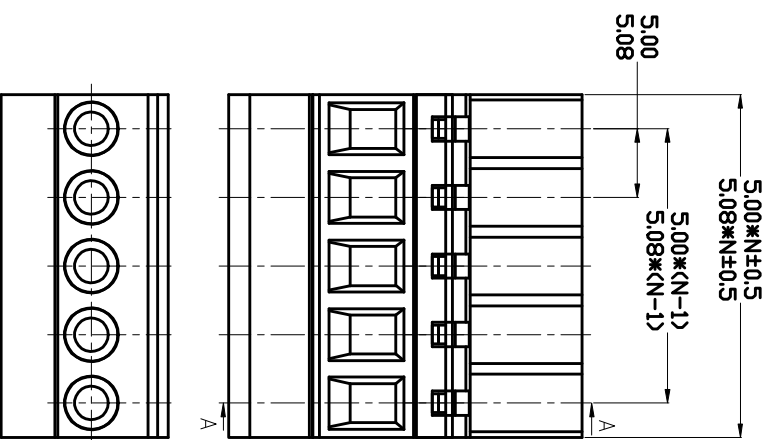
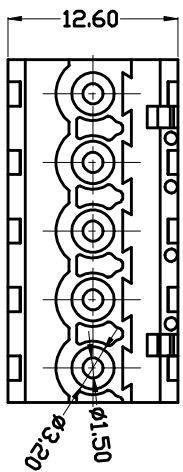

MATERIAL
SCREWS : M2.5 STEEL ZINC PLATED
CONTACT : PHOSPHOR BRONZE
HOUSING : PA66, UL94V-0

ELECTRICAL
RATED VOLTAGE : 300V
RATED CURRENT : 15A
CONTACT RESISTANCE : 20mΩ
INSULATION RESISTANCE : 500MΩ/1000V
WITHSTANDING VOLTAGE : AC1500V/1Min
WIRE RANGE : 28-12AWG 2.5mm²

MECHANICAL
TEMP RANGE : -40°C ~ +105°C
MAX SOLDERING : +250°C, FOR 5 SEC.
ORQUE : 0.5Nm(4.5IB.LIN)
STRUO LEBGTG : 7.8mm

GENERAL TOLERANCE		ANGLE TOLERANCE		PROJECTION	
X. ±0.20	X. ±0.15	X. ±2°	X. ±1°	UNITS	mm
.XX ±0.10	.XX ±0.5°	.XX ±0.5°		SHEET SIZE	A4
DRAWING TYPE		COMPONENTS		TITLE	
SCALE	1:1	SHEET	1 OF 1	PLUGGABLE TERMINAL BLOCKS	
DRAWING NO.	KF2EDGK-YS6G			PITCH 5.00/5.08MM	

KATVIBO ELECTRONICS
DFP
慈溪市凯峰电子有限公司
KAIFENG ELECTRONIC CO.,LTD